

Department of Engineering
Tim Bryan, P.E., PTOE, County Engineer

3137 South Liberty Street, Canton, MS 39046
Office (601) 855-5582 FAX (601) 859-5857

MEMORANDUM

June 16, 2026

To: Casey Brannon, Supervisor, District I
Trey Baxter, Supervisor, District II
Gerald Steen, Supervisor, District III
Karl Banks, Supervisor, District IV
Paul Griffin, Supervisor, District V

From: Tim Bryan, P.E., PTOE
County Engineer

Re: Comcast Utility Permit
County Road Name, Aurora Circle

The Engineering Department recommends approval for Comcast to pull 60' through exiting conduit then bore 56' at the county road names listed below.

- Azure Drive
- Mender Way
- Aurora Circle



PERMIT APPLICATION FOR THE CONSTRUCTION OR ADJUSTMENT OF A UTILITY WITHIN COUNTY ROAD RIGHT-OF-WAY

Utility Information: Utility Name: _____

Address: _____ City/State/Zip: _____

Contact Person: _____ Contact's Phone: _____

Project Information: County Road Name: _____
(If located within more than one road right-of-way, use Appendix 1 for additional descriptions)

Beginning Location: _____ Ending Location: _____

Length of Project: _____ Section: _____ Township: _____ Range: _____

Description of Work: _____

Check Box if Appendix 1 is to be included as a part of this Application

Whereas the above stated Utility makes application to the **Madison County Board of Supervisors** for a Construction Permit. Attached hereto are drawings and plans for the construction of the above facilities located within Madison County owned public rights-of-way. Once stamped by the Madison County Engineering Department, these plans shall not be changed or altered without written approval of the County Engineer, or his representative. A copy of the approved permit and plans shall be on-site at all times during construction.

The Applicant Utility shall comply with all policies, procedures and construction practices as outlined in *A Policy for The Accommodation of Utility Facilities within the Right-of-Way of all Public County Roads* (hereinafter referred to as the "Policy"), as adopted on November 1, 2005, by the **Madison County Board of Supervisors**, and which is hereby made a part of this Application Agreement.

If facilities are to be located within the Rights-of-Way of the County-Federal or State Aid System, Applicant Utility also agrees to comply with applicable provisions of *S.O.P. No. SA II-2-8, Accommodation of Utilities on Rights-of-Way*, issued by the State Aid Engineer and dated July 1, 2005.

The Applicant Utility understands and agrees that, except as herein granted, no right, title, claim, or easement to said road right-of-way is granted by the issuance of this permit. If this Utility is listed in the general provisions of the Policy, it will be adjusted to comply with same without cost to the County, unless the variance from the Policy has been approved by the granting of the Permit pursuant to this Application.

The Applicant Utility further understands that the Utility's engineering, plant, or other personnel will be responsible for the staking and construction supervision of the work set out above and as shown on the attached plans. If work impacts traffic in any way, the appropriate traffic control shall be installed per the *Manual of Uniform Traffic Control Devices*, Latest Edition.

The Applicant Utility understands that the County Engineer, or his representative, may issue a Stop Work Order at any time if it is deemed that site conditions are not suitable for construction or if any of the requirements of this permit are not being met.

Many County Roads have variable Rights-of-Way and/or no Right-of-Way at all and are maintained under a Prescriptive Easement. It is the sole responsibility of the Applicant Utility to verify the existence and limits of public rights-of-way. If none exists, it is the

responsibility of the Applicant Utility to acquire an easement for their Facilities from the applicable property owner(s). Madison County in no way verifies the limits of Right-of-Way as shown on the permit application.

The Applicant Utility shall be responsible for all future maintenance and repair of the facilities installed under this permit. The Applicant Utility shall make future adjustments to, or relocate, the facilities located within road or highway right-of-way when required for road or highway widening or other road or highway construction at no cost to Madison County. The Applicant Utility shall relocate said utilities within sixty (60) days of notification by County by registered mail, return receipt requested, unless otherwise designated by the County Engineer. Further, any maintenance, repair, or construction shall be done in such a manner as to occasion no unreasonable interference with the normal flow and safety to traffic and at the expense of the utility company. When reasonable care has been taken to locate said utility facilities within the right-of-way, the Applicant Utility understands that any damages caused by routine maintenance and construction by County forces shall be borne by the Applicant Utility.

The Applicant Utility further agrees to indemnify and hold Madison County harmless for any and all claims, accidents, damages, liabilities and expenses occasioned wholly, or in part, by any act or omission of applicant, its agents or employees. In case County shall, without fault on its own part, be made a party to any litigation commenced by or against applicant, then applicant shall protect and hold County harmless, and shall pay all costs, expenses and reasonable attorney's fees incurred or paid by County in connection with said litigation.

All underground facilities shall be installed at a depth equal to or greater than 48" below the lowest adjacent grade.

All pipes carrying liquid shall be encased under County maintained roads.

WITNESS the signature of the Applicant this the _____ day of _____, 20_____.

By: Kenneth Goss
(Applicant Signature)

Title: _____

Note: Applicant must be an employee of the Utility named in this application. The Madison County Board of Supervisors will not recognize a Contractor, Subcontractor, Agent, or Consulting Engineer as the Applicant. Utility Company shall be fully responsible for all work performed under this application.

I, or my authorized representative, have reviewed this application and determined that the drawing, sketches, and plans submitted by the Applicant meet the requirements of A Policy for The Accommodation of Utility Facilities within the Right-of-Way of all Public County Roads.

APPROVED
By: **By Tim Bryan at 10:47 am, Jul 02, 2026**

Tim Bryan, P.E.
County Engineer

AGREED TO AND APPROVED BY:

Madison County Board President

Date: _____

ENTERED INTO THE MINUTES OF THE BOARD OF SUPERVISORS OF MADISON COUNTY, MISSISSIPPI ON THIS _____ DAY OF _____, 20_____.

Appendix 1

County Road Name: _____
Beginning Location: _____ Ending Location: _____
Length of Project: _____ Section: _____ Township: _____ Range: _____
Description of Work: _____

County Road Name: _____
Beginning Location: _____ Ending Location: _____
Length of Project: _____ Section: _____ Township: _____ Range: _____
Description of Work: _____

County Road Name: _____
Beginning Location: _____ Ending Location: _____
Length of Project: _____ Section: _____ Township: _____ Range: _____
Description of Work: _____

County Road Name: _____
Beginning Location: _____ Ending Location: _____
Length of Project: _____ Section: _____ Township: _____ Range: _____
Description of Work: _____

County Road Name: _____
Beginning Location: _____ Ending Location: _____
Length of Project: _____ Section: _____ Township: _____ Range: _____
Description of Work: _____



COMCAST COMMUNICATIONS
 KENNETH GOSS / 601-862-4834
 121 MARKETRIDGE DR RIDGELAND , MS 39157
 kenneth_goss@comcast.com

WORK DESCRIPTION: COMCAST WILL START AT EXISTING PED AND PULL THROUGH EXISTING CONDUIT TO EXISTING PED THE BORE PLACING NEW VAULTS.

VICINITY MAP

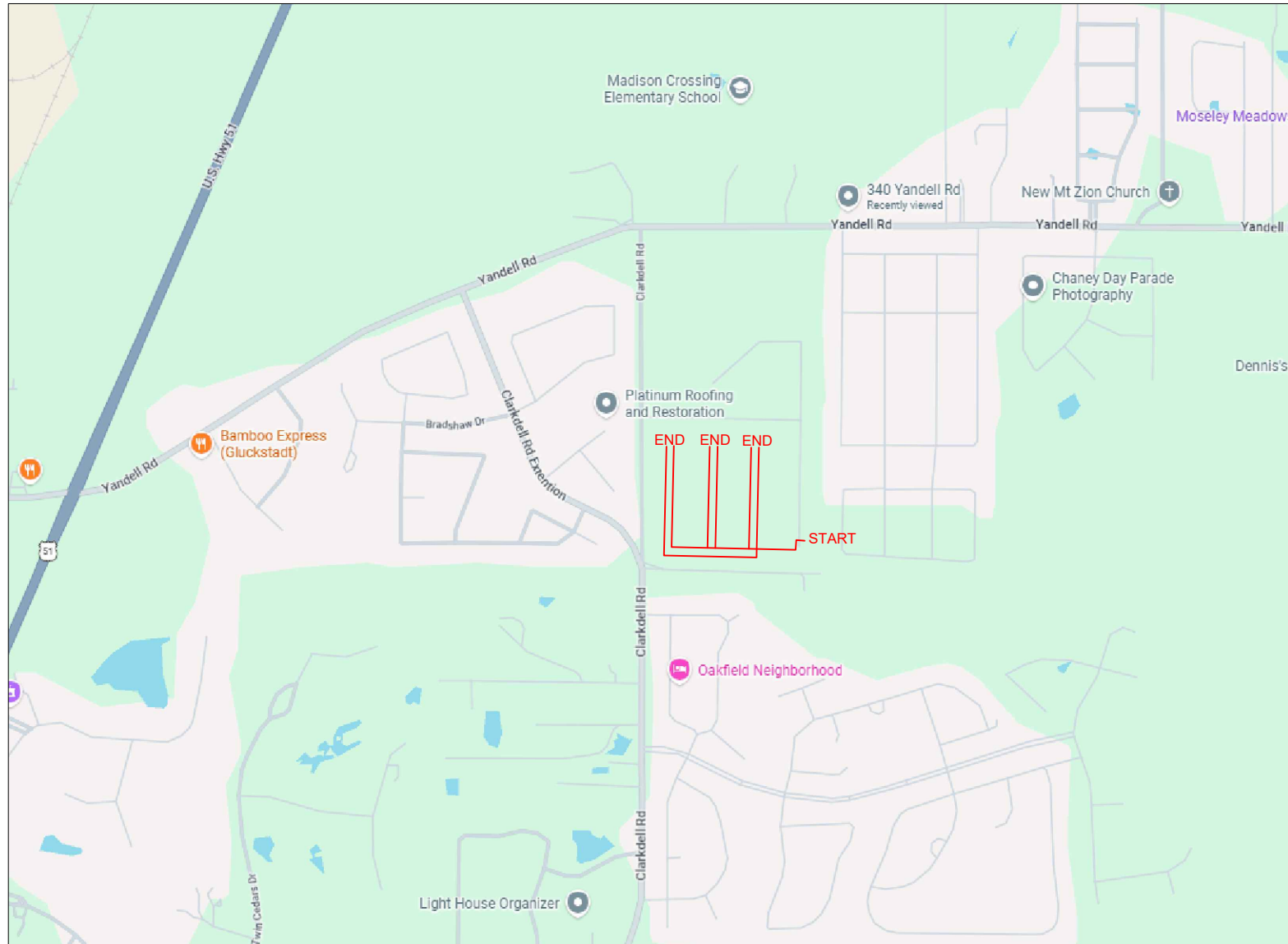

VICINITY MAP NOT TO SCALE

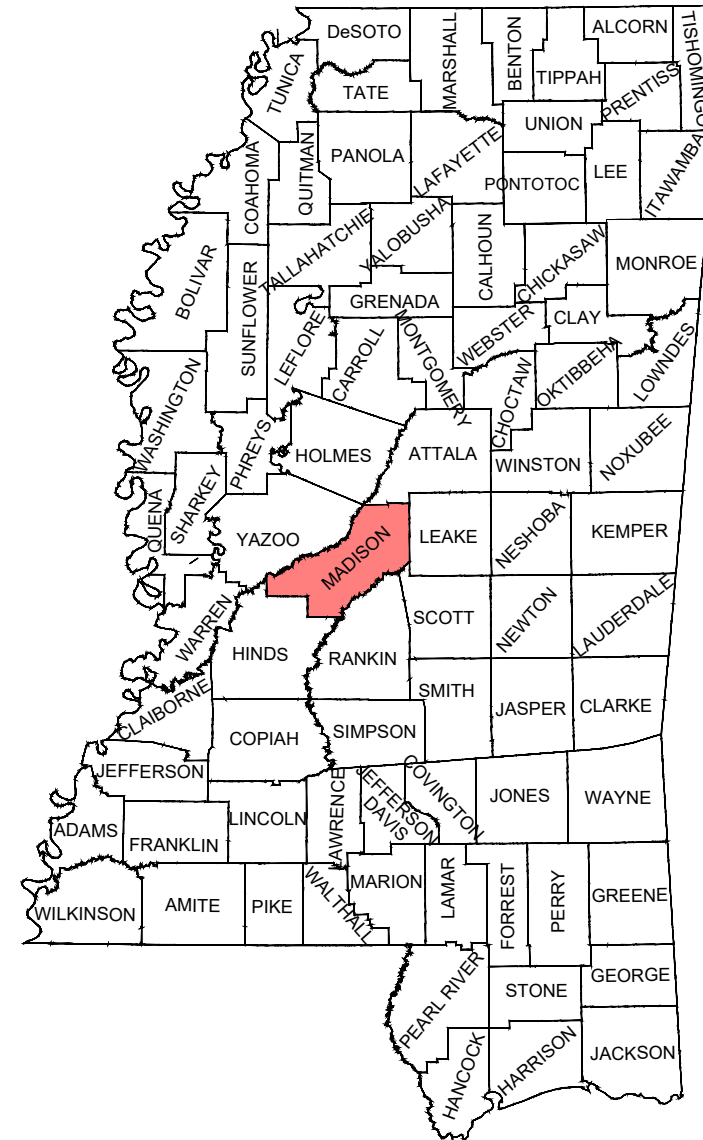

ENGINEERED BY:



ENGINEERED FOR:



LEGEND

UG	NEW UNDERGROUND
A	NEW AERIAL
A	NEW AERIAL OFF R/W
EC	EXISTING CONDUIT
UE	UTILITY EASEMENT
---	EDGE OF TRAVEL
---	SURVEY CENTERLINE
---	RIGHT OF WAY
---	DRIVEWAY
x-x	FENCE LINE
PL	PROPERTY LINE
---	SIDEWALK
---	RAILROAD
W	WATER
S	SEWER
G	GAS
SD	STORM DRAIN
T	TELCO
P	POWER
UNK	UNKNOWN UTILITY

SYMBOLS

P	NEW PEDESTAL	BRIDGE RAIL
V	NEW VAULT	NEW ANCHOR
BP	NEW BORE PIT	EXT ANCHOR
P	EXT PEDESTAL	CULVERT
V	EXT VAULT	ADA RAMP
PT	EXT TRANSFORMER	PS
T	EXT TELCO	POWER SUPPLY
SD	STORM DRAIN	RR
SI	STORM INLET	SB
TL	TRAFFIC LIGHT	RR SB
⊗	EXT POWER POLE	R ²⁵
⊗	EXT POLE OFF R/W	G
MH	EXT MANHOLE	SD
WV	WATER VAULT	○
		○

ABBREVIATIONS

EOT - EDGE OF TRAVEL
 R/W - RIGHT OF WAY
 S/W - SIDEWALK
 C/L - CENTERLINE
 D/W - DRIVEWAY
 STA. - STATION NUMBER



NO SCALE

SHEET TOTALS

NEW AERIAL: 0'	NEW OVERLASH: 0'
NEW BORE: 0'	PULL EXT CONDUIT: 0'
NEW PED: 0'	NEW VAULT: 0'

PROJECT TOTALS

NEW AERIAL: 0'	NEW OVERLASH: 0'
NEW BORE: 6,039'	PULL EXT CONDUIT: 60'
NEW PED: 0	NEW VAULT: 38

JOB #: JB0002613230
 PROJECT NAME
 MSCNAD212-UG-COUNTY
 ADDRESS, CITY, STATE, ZIP
 212 AZURE DR CANTON MS 39046
 COUNTY: MADISON

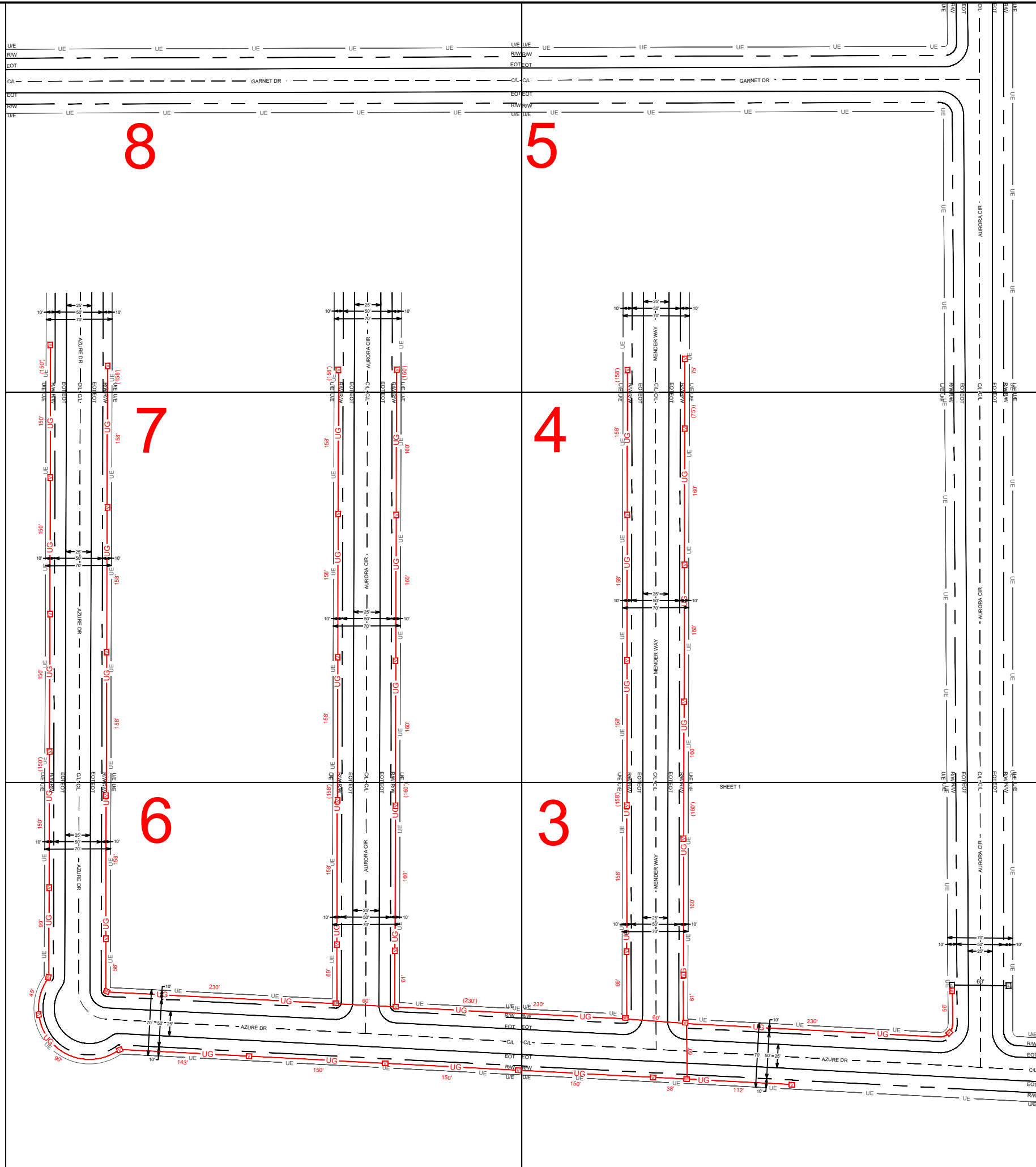

ENGINEERED BY:



ENGINEERED FOR:



LEGEND

- NEW UNDERGROUND
- NEW AERIAL
- NEW AERIAL OFF R/W
- EXISTING CONDUIT
- UTILITY EASEMENT
- EDGE OF TRAVEL
- RIGHT OF WAY
- SURVEY CENTERLINE
- DRIVEWAY
- FENCE LINE
- PROPERTY LINE
- SIDEWALK
- RAILROAD
- WATER
- SEWER
- GAS
- STORM DRAIN
- TELCO
- POWER
- UNKNOWN UTILITY

SYMBOLS

- NEW PEDESTAL
- NEW VAULT
- NEW BORE PIT
- EXT PEDESTAL
- EXT VAULT
- EXT TRANSFORMER
- EXT TELCO
- STORM DRAIN
- STORM INLET
- TRAFFIC LIGHT
- EXT POWER POLE
- EXT POLE OFF R/W
- EXT MANHOLE
- WATER VAULT
- BRIDGE RAIL
- NEW ANCHOR
- EXT ANCHOR
- CULVERT
- ADA RAMP
- POWER SUPPLY
- RAILROAD SIGNAL BOX
- RISER
- GAS MARKER
- STORM DRAIN
- FIRE HYDRANT

ABBREVIATIONS

- EOT - EDGE OF TRAVEL
- R/W - RIGHT OF WAY
- S/W - SIDEWALK
- C/L - CENTERLINE
- D/W - DRIVEWAY
- STA. - STATION NUMBER



NO SCALE

SHEET TOTALS

NEW AERIAL: 0'	NEW OVERLASH: 0'
NEW BORE: 0'	PULL EXT CONDUIT: 0'
NEW PED: 0'	NEW VAULT: 0'

PROJECT TOTALS

NEW AERIAL: 0'	NEW OVERLASH: 0'
NEW BORE: 6,039'	PULL EXT CONDUIT: 60'
NEW PED: 0	NEW VAULT: 38

JOB #: JB0002613230

PROJECT NAME
MSCNAD212-UG-COUNTY

ADDRESS, CITY, STATE, ZIP
212 AZURE DR CANTON MS 39046

COUNTY: MADISON

LEGEND

UG	NEW UNDERGROUND
A	NEW AERIAL
AO	NEW AERIAL OFF R/W
EC	EXISTING CONDUIT
UE	UTILITY EASEMENT
ET	EDGE OF TRAVEL
SW	RIGHT OF WAY
SC	SURVEY CENTERLINE
DW	DRIVEWAY
FL	FENCE LINE
PL	PROPERTY LINE
PL	SIDEWALK
RR	RAILROAD
W	WATER
S	SEWER
G	GAS
SD	STORM DRAIN
T	TELCO
P	POWER
UNK	UNKNOWN UTILITY

SYMBOLS

P	NEW PEDESTAL	BRIDGE RAIL
V	NEW VAULT	NEW ANCHOR
BP	NEW BORE PIT	EXT ANCHOR
P	EXT PEDESTAL	CULVERT
V	EXT VAULT	ADA RAMP
PT	EXT TRANSFORMER	ADA RAMP
T	EXT TELCO	ADA RAMP
SD	STORM DRAIN	PS POWER SUPPLY
SI	STORM INLET	RRB RAILROAD SIGNAL BOX
TL	TRAFFIC LIGHT	RRB RAILROAD SIGNAL BOX
EP	EXT POWER POLE	R ²⁵ RISER
EPO	EXT POLE OFF R/W	G GAS MARKER
MH	EXT MANHOLE	SD STORM DRAIN
WV	WATER VAULT	FH FIRE HYDRANT

ABBREVIATIONS

EOT	EDGE OF TRAVEL
R/W	RIGHT OF WAY
S/W	SIDEWALK
C/L	CENTERLINE
D/W	DRIVEWAY
STA.	STATION NUMBER

NO SCALE

SHEET TOTALS

NEW AERIAL:	0'	NEW OVERLASH:	0'
NEW BORE:	930'	PULL EXT CONDUIT:	0'
NEW PED:	0'	NEW VAULT:	5

PROJECT TOTALS

NEW AERIAL:	0'	NEW OVERLASH:	0'
NEW BORE:	6,039'	PULL EXT CONDUIT:	60'
NEW PED:	0	NEW VAULT:	38

JOB #: JB0002613230
 PROJECT NAME
 MSCNAD212-UG-COUNTY
 ADDRESS, CITY, STATE, ZIP
 212 AZURE DR CANTON MS 39046
 COUNTY: MADISON

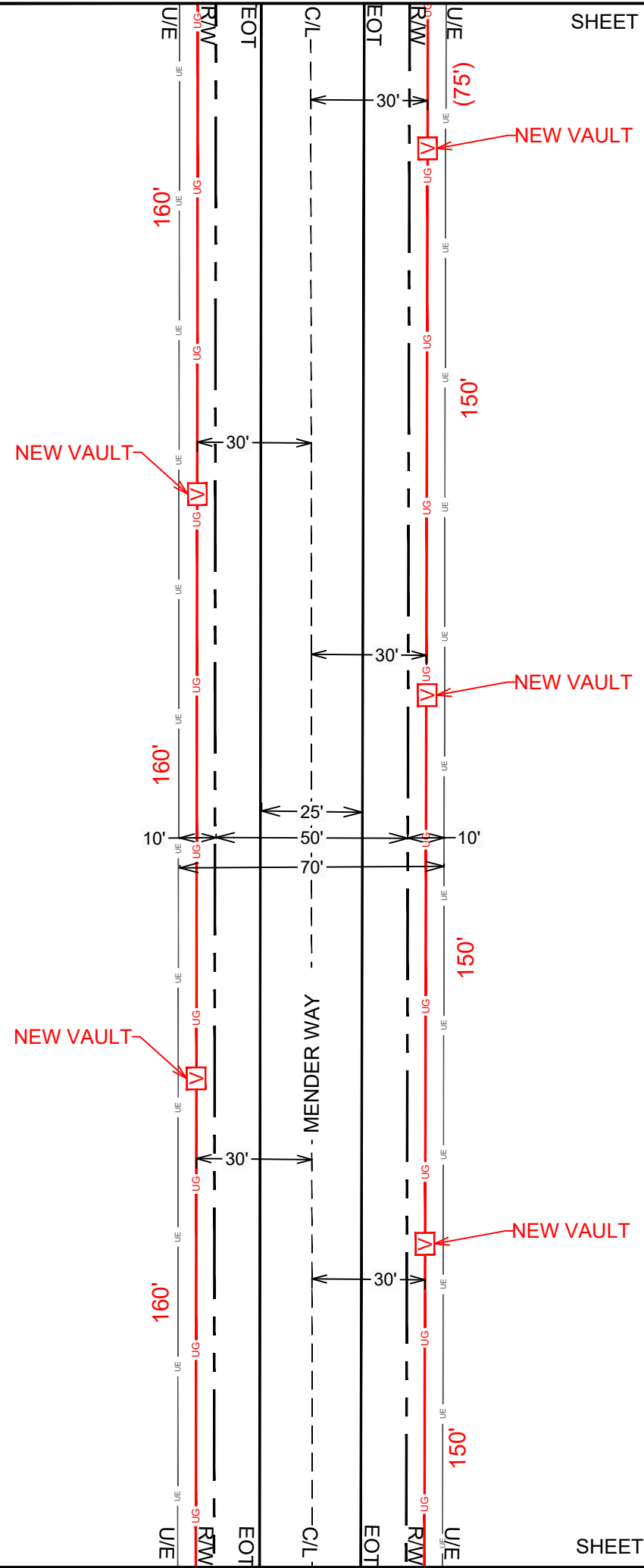
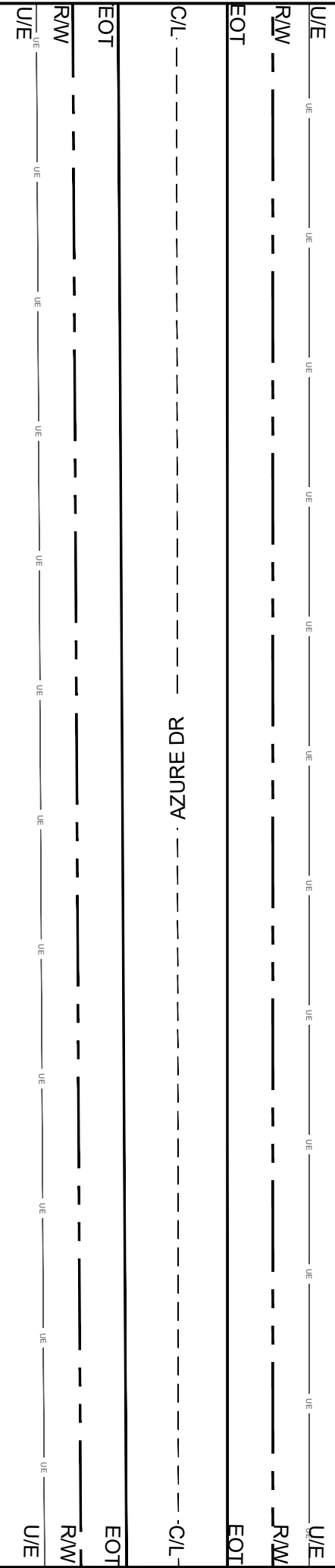

NEW BORE CONSTRUCTION NOTES

- (1) 2" HDPE CONDUIT
- 4' MINIMUM DEPTH PARALLEL AT ALL POINTS
- 4' MINIMUM DEPTH ROAD CROSSINGS AT ALL POINTS
- MAINTAIN 12" SEPARATION FROM ALL EXT UTILITIES
- ALL NEW BORE TO BE IN BACK 5' OF RIGHT OF WAY
- ALL VAULTS TO BE MOUNTED FLUSH TO GROUND
- BORE PIT TO BE FILLED SAME DAY
- VAULTS TO BE FILLED SAME DAY
- ALL HOLES TO BE TAMPED AND SODDED

ENGINEERED BY:



ENGINEERED FOR:



LEGEND

UG	NEW UNDERGROUND
A	NEW AERIAL
A	NEW AERIAL OFF R/W
EC	EXISTING CONDUIT
UE	UTILITY EASEMENT
---	EDGE OF TRAVEL
---	SURVEY CENTERLINE
---	RIGHT OF WAY
---	DRIVEWAY
x-x	FENCE LINE
PL	PROPERTY LINE
---	SIDEWALK
---	RAILROAD
W	WATER
S	SEWER
G	GAS
SD	STORM DRAIN
T	TELCO
P	POWER
UNK	UNKNOWN UTILITY

SYMBOLS

P	NEW PEDESTAL	BRIDGE RAIL	
V	NEW VAULT	NEW ANCHOR	
BP	NEW BORE PIT	EXT ANCHOR	
P	EXT PEDESTAL	CULVERT	
V	EXT VAULT	ADA RAMP	
PT	EXT TRANSFORMER	PS	POWER SUPPLY
T	EXT TELCO	RSB	RAILROAD SIGNAL BOX
SD	STORM DRAIN	R	RISER
TL	TRAFFIC LIGHT	G	GAS MARKER
⊗	EXT POWER POLE	SD	STORM DRAIN
⊗	EXT POLE OFF R/W	○	FIRE HYDRANT
MH	EXT MANHOLE		
WV	WATER VAULT		

ABBREVIATIONS

EOT - EDGE OF TRAVEL
 R/W - RIGHT OF WAY
 S/W - SIDEWALK
 C/L - CENTERLINE
 D/W - DRIVEWAY
 STA. - STATION NUMBER



NO SCALE

SHEET TOTALS

NEW AERIAL: 0'	NEW OVERLASH: 0'
NEW BORE: 75'	PULL EXT CONDUIT: 0'
NEW PED: 0'	NEW VAULT: 2

PROJECT TOTALS

NEW AERIAL: 0'	NEW OVERLASH: 0'
NEW BORE: 6,039'	PULL EXT CONDUIT: 60'
NEW PED: 0	NEW VAULT: 38

JOB #: JB0002613230

PROJECT NAME
MSCNAD212-UG-COUNTY

ADDRESS, CITY, STATE, ZIP
212 AZURE DR CANTON MS 39046

COUNTY: MADISON

SHEET 5 OF 9

NEW BORE CONSTRUCTION NOTES

- (1) 2" HDPE CONDUIT
- 4' MINIMUM DEPTH PARALLEL AT ALL POINTS
- 4' MINIMUM DEPTH ROAD CROSSINGS AT ALL POINTS
- MAINTAIN 12" SEPARATION FROM ALL EXT UTILITIES
- ALL NEW BORE TO BE IN BACK 5' OF RIGHT OF WAY
- ALL VAULTS TO BE MOUNTED FLUSH TO GROUND
- BORE PIT TO BE FILLED SAME DAY
- VAULTS TO BE FILLED SAME DAY
- ALL HOLES TO BE TAMPED AND SODDED

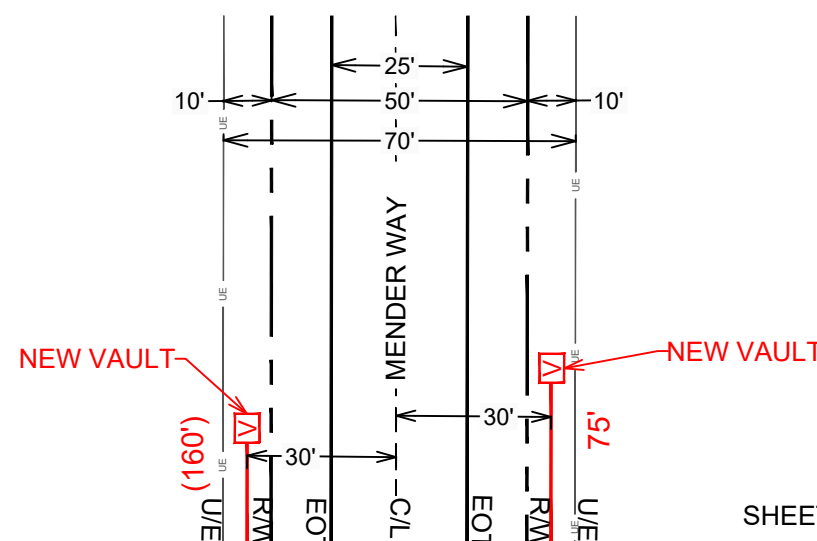

SHEET 4

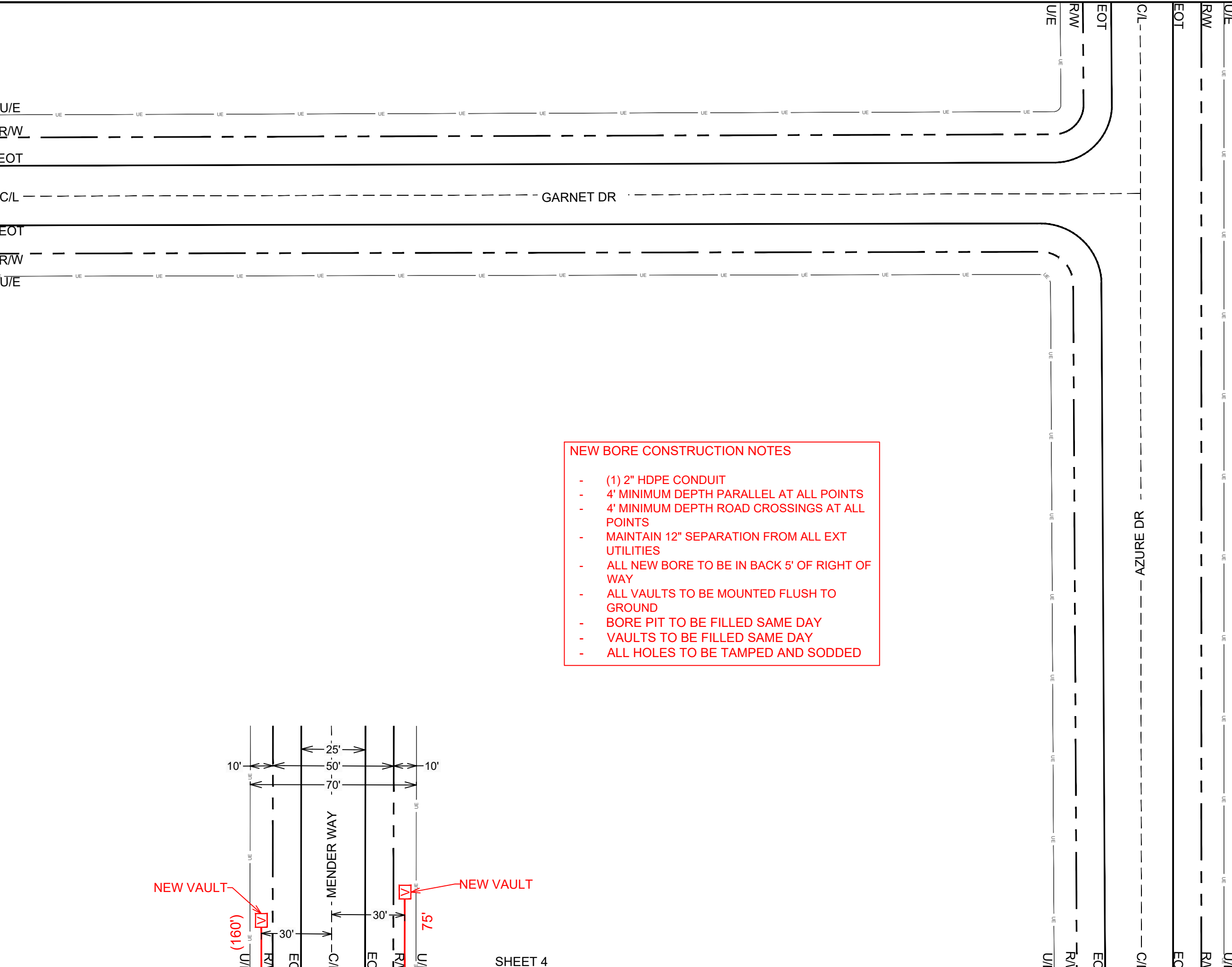



NEW BORE CONSTRUCTION NOTES

- (1) 2" HDPE CONDUIT
- 4' MINIMUM DEPTH PARALLEL AT ALL POINTS
- 4' MINIMUM DEPTH ROAD CROSSINGS AT ALL POINTS
- MAINTAIN 12" SEPARATION FROM ALL EXT UTILITIES
- ALL NEW BORE TO BE IN BACK 5' OF RIGHT OF WAY
- ALL VAULTS TO BE MOUNTED FLUSH TO GROUND
- BORE PIT TO BE FILLED SAME DAY
- VAULTS TO BE FILLED SAME DAY
- ALL HOLES TO BE TAMPED AND SODDED

LEGEND

UG	NEW UNDERGROUND
A	NEW AERIAL
EA	NEW AERIAL OFF R/W
EC	EXISTING CONDUIT
UE	UTILITY EASEMENT
ET	EDGE OF TRAVEL
SC	SURVEY CENTERLINE
R/W	RIGHT OF WAY
D/W	DRIVEWAY
PL	FENCE LINE
PL	PROPERTY LINE
S	SIDWALK
R	RAILROAD
W	WATER
S	SEWER
G	GAS
SD	STORM DRAIN
T	TELCO
P	POWER
UNK	UNKNOWN UTILITY

SYMBOLS

P	NEW PEDESTAL	BRIDGE RAIL
V	NEW VAULT	NEW ANCHOR
BP	NEW BORE PIT	EXT ANCHOR
P	EXT PEDESTAL	CULVERT
V	EXT VAULT	ADA RAMP
PT	EXT TRANSFORMER	PS
T	EXT TELCO	POWER SUPPLY
SD	STORM DRAIN	RR
SI	STORM INLET	RR
TL	TRAFFIC LIGHT	SB
EP	EXT POWER POLE	R
EP	EXT POLE OFF R/W	R ²⁵
MH	EXT MANHOLE	G
WV	WATER VAULT	G
		SD
		SD
		FH
		FH

ABBREVIATIONS

EOT	- EDGE OF TRAVEL
R/W	- RIGHT OF WAY
S/W	- SIDEWALK
C/L	- CENTERLINE
D/W	- DRIVEWAY
STA.	- STATION NUMBER

SHEET TOTALS

NEW AERIAL:	0'	NEW OVERLASH:	0'
NEW BORE:	1,781'	PULL EXT CONDUIT:	0'
NEW PED:	0'	NEW VAULT:	12







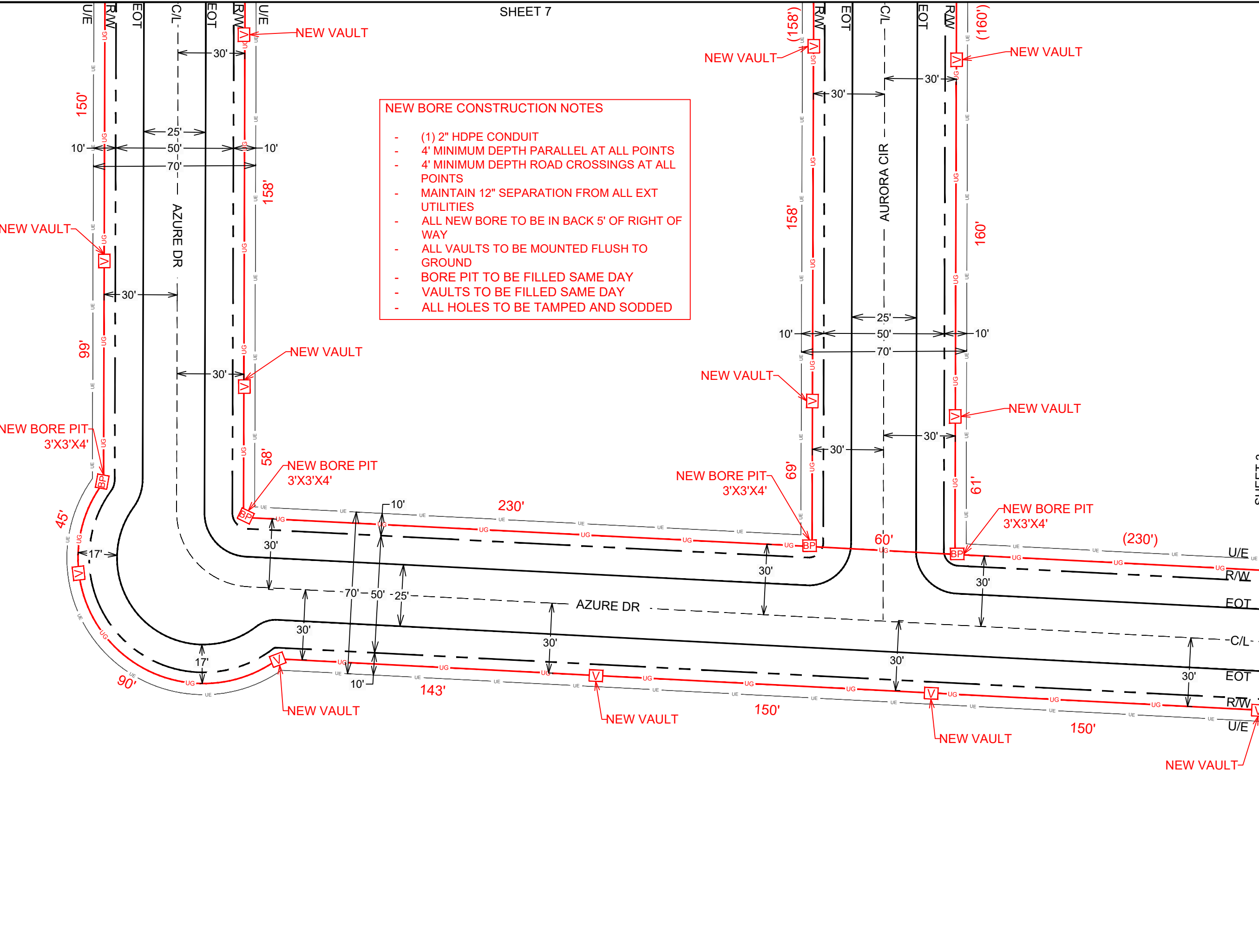













PROJECT TOTALS

NEW AERIAL:	0'	NEW OVERLASH:	0'
NEW BORE:	6,039'	PULL EXT CONDUIT:	60'
NEW PED:	0	NEW VAULT:	38















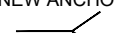







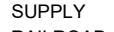

JOB #: JB0002613230
 PROJECT NAME
 MSCNAD212-UG-COUNTY
 ADDRESS, CITY, STATE, ZIP
 212 AZURE DR CANTON MS 39046
 COUNTY: MADISON

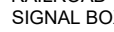

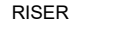
LEGEND

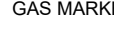
	UG	NEW UNDERGROUND
	A	NEW AERIAL
	A	NEW AERIAL OFF R/W
	EC	EXISTING CONDUIT
	UE	UTILITY EASEMENT
		EDGE OF TRAVEL
		SURVEY CENTERLINE
		RIGHT OF WAY
		DRIVEWAY
	x	FENCE LINE
	PL	PROPERTY LINE
		SIDEWALK
	R	RAILROAD
	W	WATER
	S	SEWER
	G	GAS
	SD	STORM DRAIN
	T	TELCO
	P	POWER
	UNK	UNKNOWN UTILITY

SYMBOLS

	NEW PEDESTAL		BRIDGE RAIL
	NEW VAULT		NEW ANCHOR
	NEW BORE PIT		EXT ANCHOR
	EXT PEDESTAL		CULVERT
	EXT VAULT		ADA RAMP
	EXT TRANSFORMER		POWER SUPPLY
	EXT TELCO		RAILROAD SIGNAL BOX
	STORM DRAIN		RISER
	STORM INLET		GAS MARKER
	TRAFFIC LIGHT		STORM DRAIN
	EXT POWER POLE		FIRE HYDRANT
	EXT POLE OFF R/W		
	EXT MANHOLE		
	WATER VAULT		

ABBREVIATIONS

EOT - EDGE OF TRAVEL
R/W - RIGHT OF WAY
S/W - SIDEWALK
C/L - CENTERLINE
D/W - DRIVEWAY
STA. - STATION NUMBER



NO SCALE

SHEET TOTALS

NEW AERIAL: 0'	NEW OVERLASH: 0'
NEW BORE: 1,878'	PULL EXT CONDUIT: 0'
NEW PED: 0'	NEW VAULT: 9

PROJECT TOTALS

NEW AERIAL: 0'	NEW OVERLASH: 0'
NEW BORE: 6,039'	PULL EXT CONDUIT: 60'
NEW PED: 0	NEW VAULT: 38

JOB #: JB0002613230

PROJECT NAME
 MSCNAD212-UG-COUNTY

ADDRESS, CITY, STATE, ZIP
 212 AZURE DR CANTON MS 39046

COUNTY: MADISON

NEW BORE CONSTRUCTION NOTES

- (1) 2" HDPE CONDUIT
- 4' MINIMUM DEPTH PARALLEL AT ALL POINTS
- 4' MINIMUM DEPTH ROAD CROSSINGS AT ALL POINTS
- MAINTAIN 12" SEPARATION FROM ALL EXT UTILITIES
- ALL NEW BORE TO BE IN BACK 5' OF RIGHT OF WAY
- ALL VAULTS TO BE MOUNTED FLUSH TO GROUND
- BORE PIT TO BE FILLED SAME DAY
- VAULTS TO BE FILLED SAME DAY
- ALL HOLES TO BE TAMPED AND SODDED

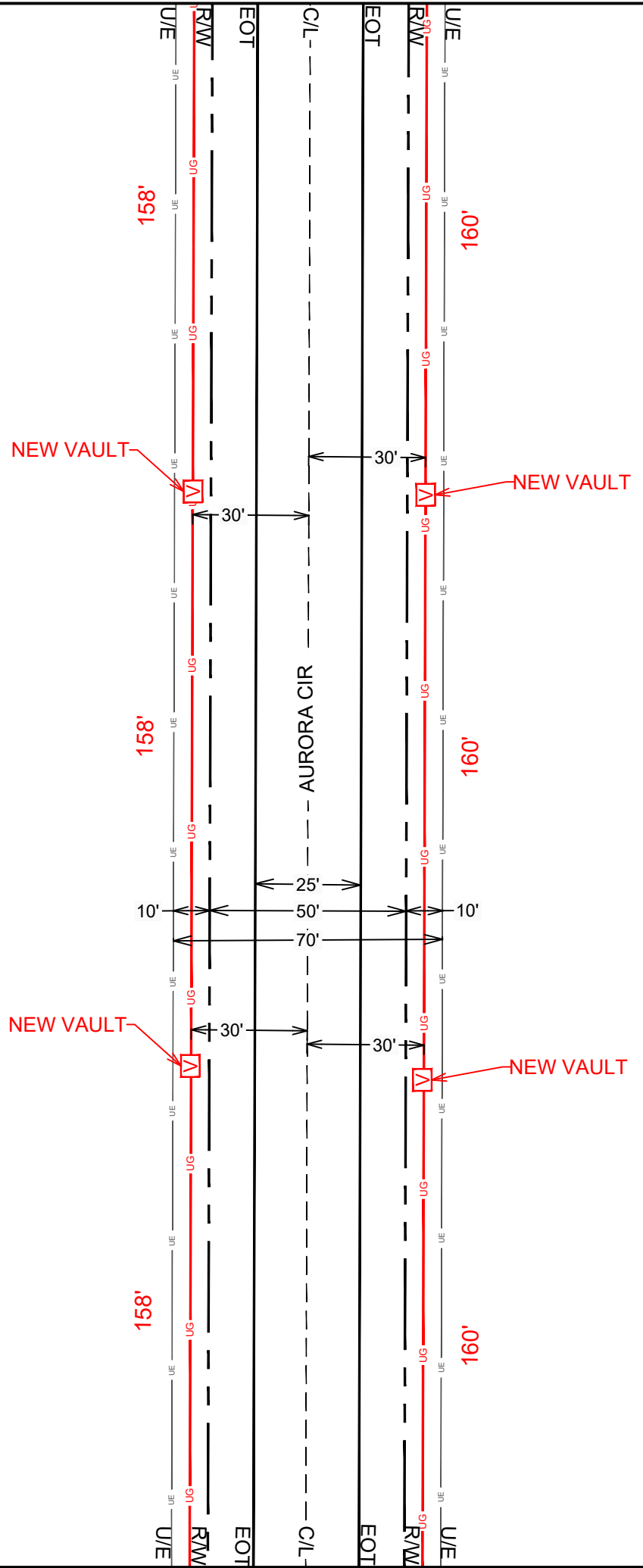
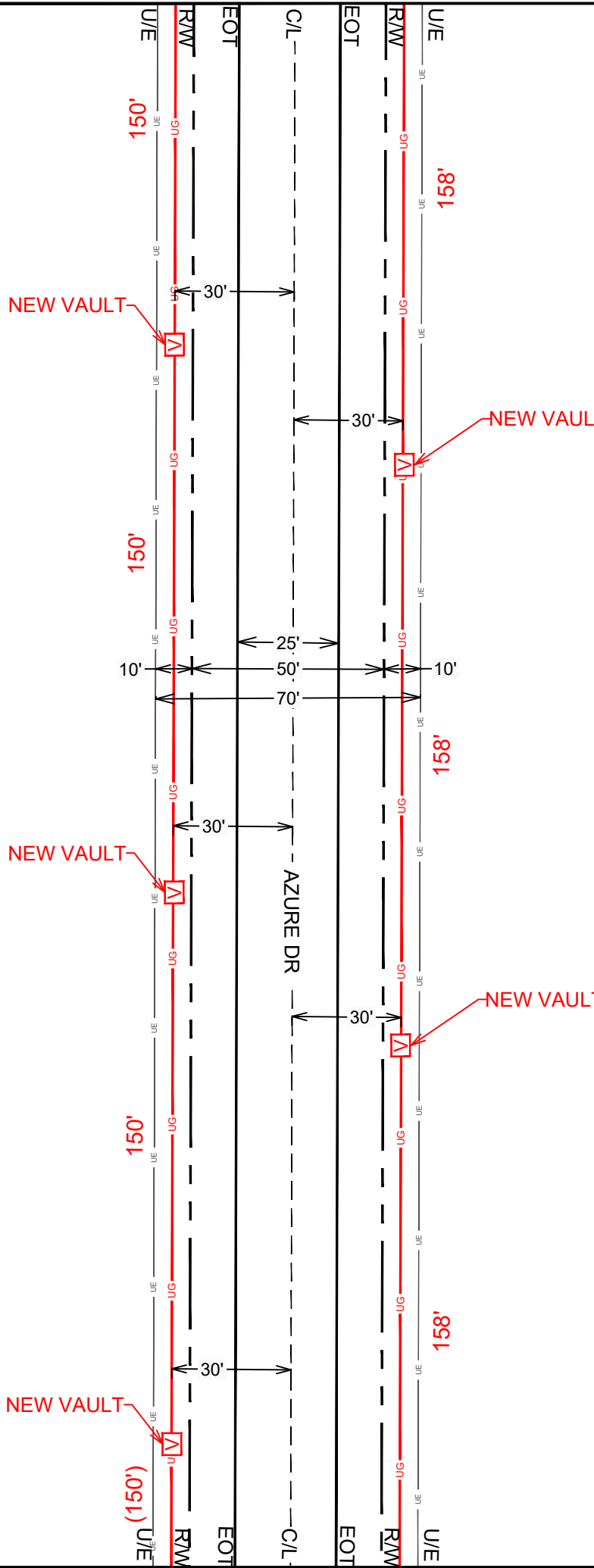

ENGINEERED BY:



ENGINEERED FOR:



LEGEND

UG	NEW UNDERGROUND
A	NEW AERIAL
A	NEW AERIAL OFF R/W
EC	EXISTING CONDUIT
UE	UTILITY EASEMENT
---	EDGE OF TRAVEL
---	SURVEY CENTERLINE
---	RIGHT OF WAY
---	DRIVEWAY
x-x	FENCE LINE
PL	PROPERTY LINE
---	SIDEWALK
	RAILROAD
W	WATER
S	SEWER
G	GAS
SD	STORM DRAIN
T	TELCO
P	POWER
UNK	UNKNOWN UTILITY

SYMBOLS

P	NEW PEDESTAL	BRIDGE RAIL
V	NEW VAULT	NEW ANCHOR
BP	NEW BORE PIT	EXT ANCHOR
P	EXT PEDESTAL	CULVERT
V	EXT VAULT	ADA RAMP
PT	EXT TRANSFORMER	PS
T	EXT TELCO	POWER SUPPLY
SD	STORM DRAIN	RR
SI	STORM INLET	RR SB
TL	TRAFFIC LIGHT	RAILROAD SIGNAL BOX
⊗	EXT POWER POLE	R ²⁵
⊗	EXT POLE OFF R/W	G
MH	EXT MANHOLE	SD
WV	WATER VAULT	○
		FIRE HYDRANT

ABBREVIATIONS

EOT - EDGE OF TRAVEL
R/W - RIGHT OF WAY
S/W - SIDEWALK
C/L - CENTERLINE
D/W - DRIVEWAY
STA. - STATION NUMBER



NO SCALE

SHEET TOTALS

NEW AERIAL: 0'	NEW OVERLASH: 0'
NEW BORE: 0'	PULL EXT CONDUIT: 0'
NEW PED: 0'	NEW VAULT: 4

PROJECT TOTALS

NEW AERIAL: 0'	NEW OVERLASH: 0'
NEW BORE: 6,039'	PULL EXT CONDUIT: 60'
NEW PED: 0	NEW VAULT: 38

JOB #: JB0002613230

PROJECT NAME
MSCNAD212-UG-COUNTY

ADDRESS, CITY, STATE, ZIP
212 AZURE DR CANTON MS 39046

COUNTY: MADISON

SHEET 8 OF 9

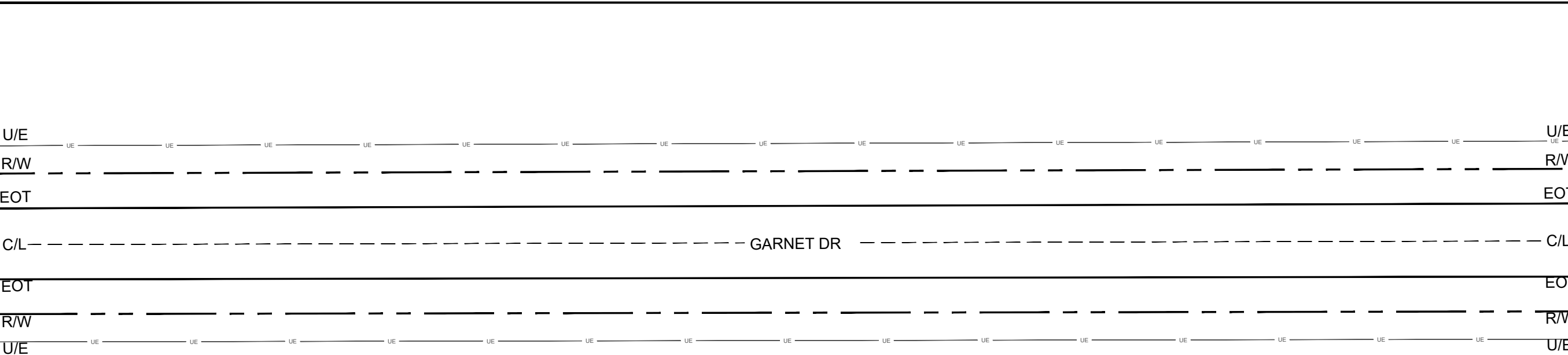

NEW BORE CONSTRUCTION NOTES

- (1) 2" HDPE CONDUIT
- 4' MINIMUM DEPTH PARALLEL AT ALL POINTS
- 4' MINIMUM DEPTH ROAD CROSSINGS AT ALL POINTS
- MAINTAIN 12" SEPARATION FROM ALL EXT UTILITIES
- ALL NEW BORE TO BE IN BACK 5' OF RIGHT OF WAY
- ALL VAULTS TO BE MOUNTED FLUSH TO GROUND
- BORE PIT TO BE FILLED SAME DAY
- VAULTS TO BE FILLED SAME DAY
- ALL HOLES TO BE TAMPED AND SODDED

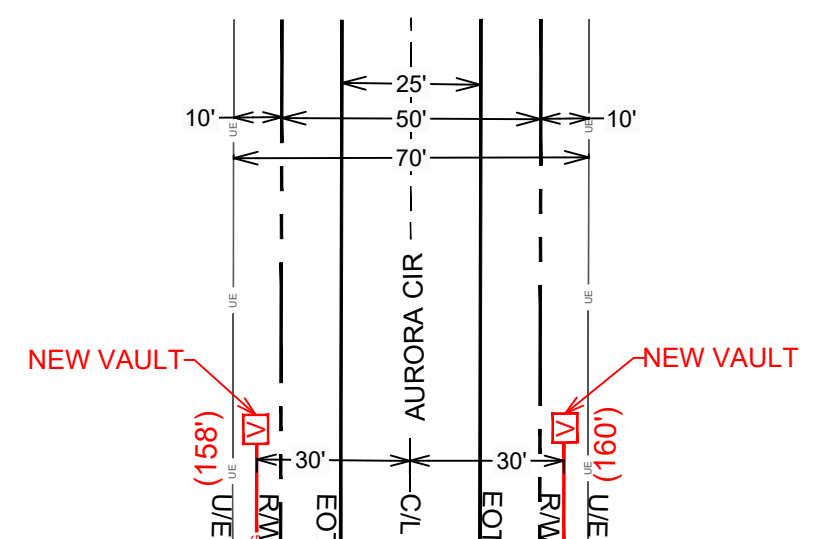
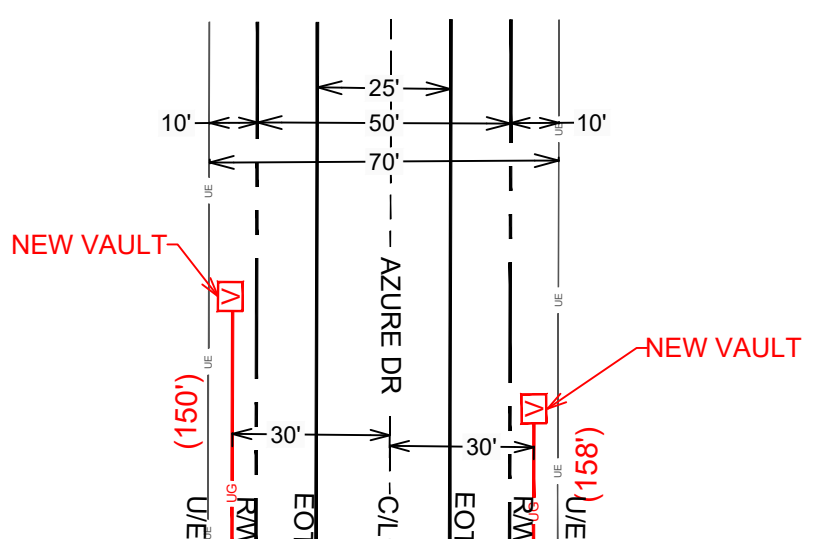

STATE HWY
TYPICAL AERIAL
HEIGHT

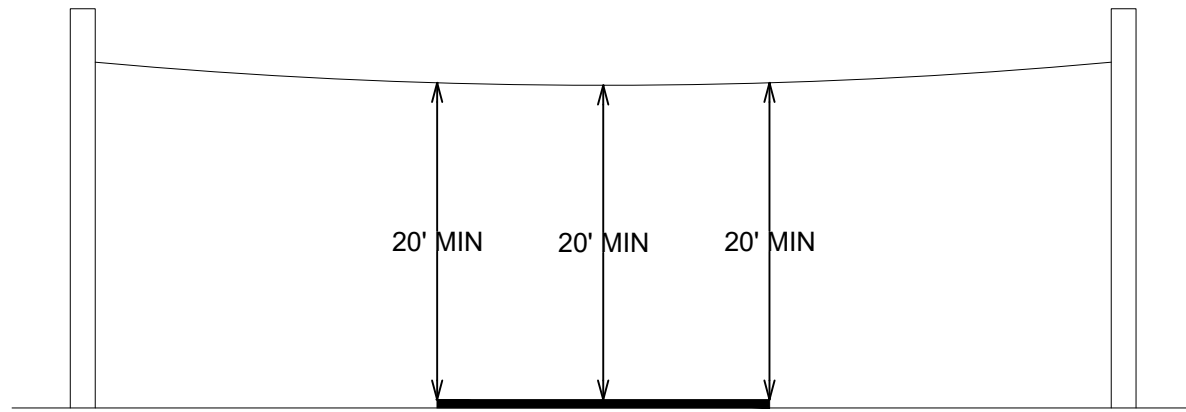

TYPICAL ROAD CROSSING
DEPTH

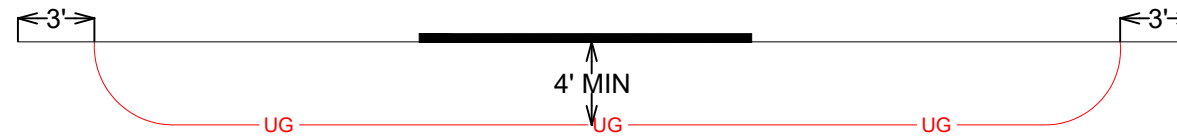

INTERSTATE
TYPICAL AERIAL
HEIGHT

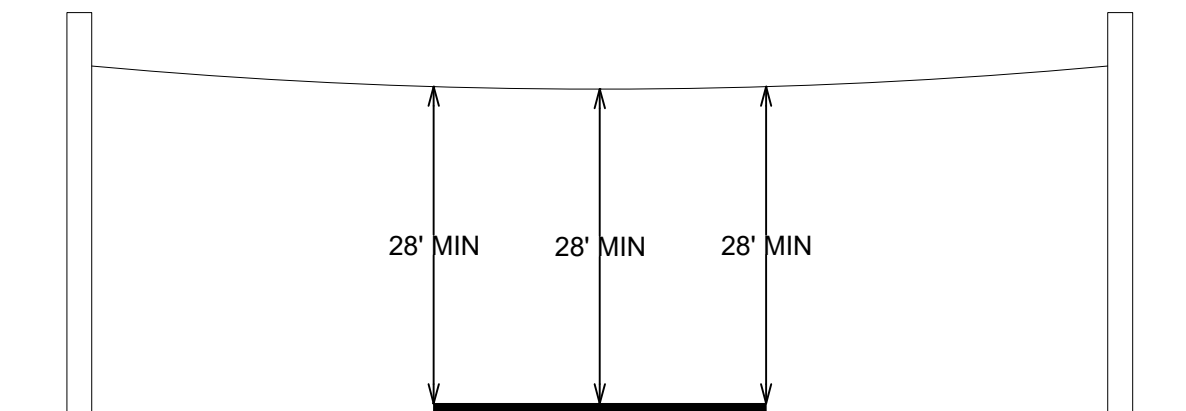

TYPICAL LONGITUDINAL BORE
DEPTH



ENGINEERED BY:



ENGINEERED FOR:



LEGEND

	UG	NEW UNDERGROUND
	A	NEW AERIAL
	A	NEW AERIAL OFF R/W
	EC	EXISTING CONDUIT
	UE	UTILITY EASEMENT
		EDGE OF TRAVEL
		SURVEY CENTERLINE
		RIGHT OF WAY
		DRIVEWAY
		FENCE LINE
	PL	PROPERTY LINE
		SIDEWALK
		RAILROAD
	W	WATER
	S	SEWER
	G	GAS
	SD	STORM DRAIN
	T	TELCO
	P	POWER
	UNK	UNKNOWN UTILITY

SYMBOLS

	NEW PEDESTAL		BRIDGE RAIL
	NEW VAULT		NEW ANCHOR
	NEW BORE PIT		EXT ANCHOR
	EXT PEDESTAL		CULVERT
	EXT VAULT		ADA RAMP
	EXT TRANSFORMER		POWER SUPPLY
	EXT TELCO		RAILROAD SIGNAL BOX
	STORM DRAIN		RISER
	STORM INLET		GAS MARKER
	TRAFFIC LIGHT		STORM DRAIN
	EXT POWER POLE		FIRE HYDRANT
	EXT POLE OFF R/W		
	EXT MANHOLE		
	WATER VAULT		

ABBREVIATIONS

EOT - EDGE OF TRAVEL
R/W - RIGHT OF WAY
S/W - SIDEWALK
C/L - CENTERLINE
D/W - DRIVEWAY
STA. - STATION NUMBER



SHEET TOTALS

NEW AERIAL: 0'	NEW OVERLASH: 0'
NEW BORE: 0'	PULL EXT CONDUIT: 0'
NEW PED: 0'	NEW VAULT: 0'

PROJECT TOTALS

NEW AERIAL: 0'	NEW OVERLASH: 0'
NEW BORE: 6,039'	PULL EXT CONDUIT: 60'
NEW PED: 0	NEW VAULT: 38

JOB #: JB0002613230

PROJECT NAME

MSCNAD212-UG-COUNTY

ADDRESS, CITY, STATE, ZIP

212 AZURE DR CANTON MS 39046

COUNTY: MADISON